

KEY PIN SHACKLES

[download pdf \(50 Kb.\)](#)

High Polished Stainless Steel - AISI 304

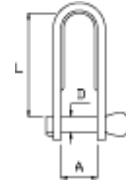

Cat. No.	D (mm.)	A (mm.)	L (mm.)	Break Load (Kg.)	Kg./100	PACK (Pcs.)
180004	4	11	20	600	0,5	100
180005	5	15	36	1.000	1,8	100
185205	5	13	26	1.000	1,5	100
180006	6	15	40	1.650	2,9	25
186106	6	14	25	1.650	2	25
180008	8	20	41	2.750	5	25

Note: All breakloads are determined by pin.

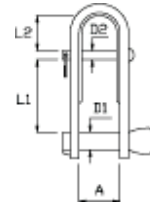

Cat. No.	D1 (mm.)	D2 (mm.)	A (mm.)	L1 (mm.)	L2 (mm.)	Break Load (Kg.)	Kg./100	PACK (Pcs.)
180352	5	3	12	14	9	700	1,6	25
180305	5	3	15	21	12	700	1,9	25
180361	6	3	14	14	9	1.500	2,1	25
180306	6	3	14	25	12	1.500	3	25
180308	8	3	20	26	12	2.000	5,1	25

Note: All breakloads are determined by pin.



Buscarons, 6 - 08022 Barcelona | Tel.: (+34) 934 186 632 | Fax: (+34) 934 185 648

E-Mail: info@allrig.net | www.allrig.net