

**THREADED SHACKLES**

[download pdf \(50 Kb.\)](#)

High Polished Stainless Steel - AISI 304

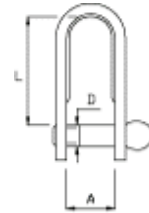

Cat. No.	D (mm.)	A (mm.)	L (mm.)	Break Load (Kg.)	Kg./100	PACK (Pcs.)
150041	M4	10	15	500	0,5	100
150042	M4	11	20	500	0,6	100
150051	M5	12	17	1.000	1	100
150052	M5	16	24	1.000	1,6	100
150053	M5	16	36	1.100	1,8	100
155251	M5	13,5	25	1.100	1,5	100
150054	M5	21	37,5	1.100	2,1	50
155206	M6	16	23	1.400	1,6	50
150062	M6	14	40	2.000	2,9	50
150064	M6	26	46	1.800	5,5	50
150082	M8	18	42	3.000	5	50

Note: All breakloads are determined by pin and thread.

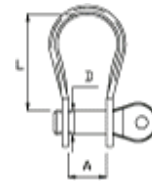

Cat. No.	D	A (mm.)	L (mm.)	Break Load (Kg.)	Kg./100	PACK (Pcs.)
150061	M6	14	23	2.000	2,5	50
150081	M8	17	31	3.000	4,5	50
150010	M10	21	40	4.800	8,5	25
150012	M12	25	50	7.000	16	25

Note: All breakloads are determined by pin and thread.

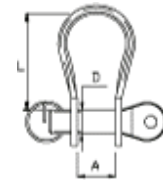

Cat. No.	D	A (mm.)	L (mm.)	Break Load (Kg.)	Kg./100	PACK (Pcs.)
156161	M6	14	23	2.000	2,7	50
156262	M6	14	40	2.000	3,1	50
158181	M8	17	31	3.000	4,8	50
158282	M8	18	42	3.000	5,3	50
151010	M10	21	40	4.800	9	25
151212	M12	25	50	7.000	16,5	25

Note: All breakloads are determined by pin and thread.



Cat. No.	D	A (mm.)	L (mm.)	Break Load (Kg.)	Kg./100	PACK (Pcs.)
160041	M4	10	15	500	0,5	100
160042	M4	11	20	500	0,6	100
160051	M5	12	17	1.000	1	100
160052	M5	16	24	1.000	1,6	100
160053	M5	16	36	1.100	1,8	100
165251	M5	13,5	25	1.100	1,5	100
165206	M6	16	23	1.400	1,6	50

Note: All breakloads are determined by pin and thread.

back

**allRIG**

Buscarons, 6 - 08022 Barcelona | Tel.: (+34) 934 186 632 | Fax: (+34) 934 185 648

E-Mail: [info@allrig.net](mailto:info@allrig.net) | [www.allrig.net](http://www.allrig.net)