

TWISTED SHACKLES[download pdf \(50 Kb.\)](#)

High Polished Stainless Steel - AISI 304

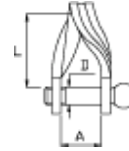

Cat. No.	D	A (mm.)	L (mm.)	Break Load (Kg.)	Kg./100	PACK (Pcs.)
170005	M5	12	22	1.200	1,5	100
170053	M5	12	33	1.200	1,7	100
170006	M6	14	36	2.000	2,9	25
170008	M8	18	36	3.000	5	25

Note: All breakloads are determined by pin and thread.

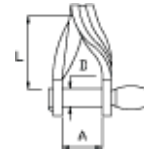

Cat. No.	D (mm.)	A (mm.)	L (mm.)	Break Load (Kg.)	Kg./100	PACK (Pcs.)
170005	5	15	32	700	1,5	25
170006	6	14	36	2.000	2,9	25

Note: All breakloads are determined by pin and thread.

[back](#)