

RIGGING SCREWS FORK-WIRE

Metric

[download pdf \(50 Kb.\)](#)

High Polished Stainless Steel - AISI 316
 Chromed Bronze Body

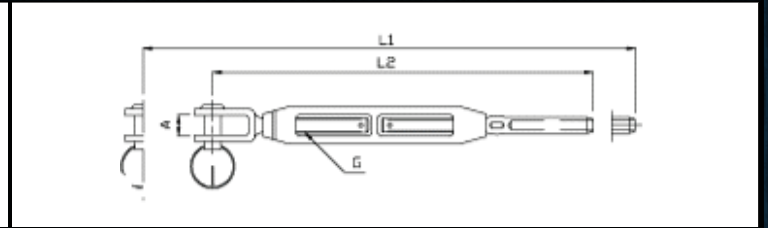

Cat. No.	G (metr.)	WIRE (metr.)	L1 (mm.)	L2 (mm.)	A (mm.)	Pin Size (mm.)	Break Load (Kg.)	Kg./100	PACK (Pcs.)
130306	M6	3	250	174	9,5	6	1.300	10,7	10
130406	M6	4	259	184	9,5	6	1.300	11	10
130408	M8	4	295	204	11	8	2.350	14,5	10
130510	M10	5	329	233	12	9,5	3.500	23,2	10
130612	M12	6	415	291	14	12	5.100	55	5
130712	M12	7	423	299	14	12	5.100	55,5	5
130816X	M16	8	516	364	18	16	8.000	109,5	BULK
131020	M20	10	613	431	24	19	13.000	191	BULK
131220X	M20	12	648	466	24	19	13.000	194	BULK

Note: All breakloads are determined by clevis pin & thread.
 The user is responsible for choosing the proper cable diameter and for correct assembly.

[back](#)