

## THREAD EYES

[download pdf \(50 Kb.\)](#)

High Polished Stainless Steel - AISI 316

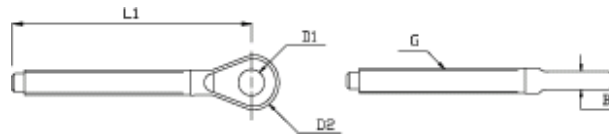

Cat. No. RIGHT	Cat. No. LEFT	G (U.N. F.)	D1 (mm.)	D2 (mm.)	L1 (mm.)	B (mm.)	Break Load (Kg.)	Kg./100	Pack (Pcs.)
021906A	031906A	1/4"	6,5	14	65	4	1.300	1,5	25
021908A	031908A	5/16"	8,5	17	78	5	2.350	3,1	25
021910A	031910A	3/8"	10,5	22	89	6	3.500	5,1	25
021911A	031911A	7/16"	13,5	25	92	8	4.700	9	10
021911AX	031911AX	7/16"	11,5	24	98	8	4.700	8,9	10
021912A	031912A	1/2"	13	25	110	8	5.400	10,1	10
021912AX	031912AX	1/2"	13,2	28	105	10	5.400	12	10
021916A	031916A	5/8"	14,5	31	134	10	8.000	20,4	10
021916AX	031916AX	5/8"	16,5	36	141	12	8.000	25,3	10
021920AX	031920AX	3/4"	19,5	40	165	16	13.000	47,7	5
021922AX	031922AX	7/8"	23	47	196,5	18	17.000	74,2	BULK
021925AX	031925AX	1"	26	52	230	20	24.000	108,3	BULK
021927AX	031927AX	1-1/8"	28,5	65	247	25	27.000	132	BULK
021930AX	031930AX	1-1/4"	32,5	70	274	30	31.000	188	BULK
021936AX	031936AX	1-3/8"	35,5	75	297	30	43.000	250	BULK

Note: All breakloads are determined by eye (D1) and thread.  
The user is responsible for choosing the proper cable diameter and for correct assembly.

[back](#)

