

## THREAD TERMINALS

[download pdf \(50 Kb.\)](#)

Stainless Steel - AISI 316

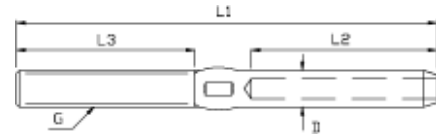

Cat. No. RIGHT	Cat. No. LEFT	G (metr.)	Wire (Dim.) (mm.)	L1 (mm.)	L2 (mm.)	L3 (mm.)	D (mm.)	Break Load (Kg.)	Kg./100	PACK (Pcs.)
900205	910205	M5	2	87	32	42	5,5	800	1,4	BULK
902505	912505	M5	2,5	87	32	42	5,5	800	1,5	BULK
900306	910306	M6	3	100	38	48	6,35	1.300	2	BULK
900406	910406	M6	4	110	45	48	7,5	1.300	2,4	BULK
900408	910408	M8	4	117	45	57	7,5	2.350	3	BULK
900508	910508	M8	5	125	51	57	9	2.350	4	BULK
900510	910510	M10	5	130	51	63	9	3.500	4,5	BULK
900610	910610	M10	6	145	64	63	12,58	3.500	8,4	BULK
900612	910612	M12	6	162	64	80	12,58	5.100	11	BULK
900714	910714	M14	7	180	70	89	14,2	5.900	16	BULK
900816	910816	M16	8	203	83	100	16	8.000	23	BULK
901020	911020	M20	10	230	89	120	17,8	13.000	35	BULK
901220	911220	M20	12	249	105	120	20	13.000	45	BULK
901220X	911220X	M20	12	265	120	120	21,4	13.000	50	BULK
901422	911422	M22	14	308	140	140	25	17.000	76,8	BULK
901624	911624	M24	16	363	160	170	28	23.000	111	BULK

Note: All breakloads are determined by thread.

The user is responsible for choosing the proper cable diameter and for correct assembly.

[back](#)

